

No.61775 HG METAL TAIL BLADE HOLDER SET \varnothing 5 Assembly manual

No.61776 HG METAL TAIL BLADE HOLDER SET \varnothing 6 Assembly manual

【Compatibility】 No.61775 VIBE50/VIBE NEX50/NEX E8/SYE12/ASE12/ASE8/AS50T2/AS90/GSR260Z Series
 No.61776 VIBE90 SG/VIBE SG E12 Series

【Assembly steps】

- ① Assemble the tail slide ring. Please note that it has a reverse thread.
- ② Install the tail PC link to the tail PC plate using the HG tail PC link pin.
- ③ Once the tail PC link is installed, tighten the setscrew M2×2.
- ④ Install the joint ball screw L4 to the HG metal tail blade holder.
- ⑤ Install the O-ring 3.5×5.5×1 to the HG center hub first. Then install the HG metal tail blade holder, washer 8×10×0.5, thrust bearing 5×10×4, flat washer M3, and the socket head bolt M3×8 in this order.
 The thrust bearing has a front and back. Do not make a mistake when installing it.
- ⑥ Install the assembled tail PC plate to the tail output shaft first. Next install the tail hub and secure the setscrew M4×4.
- ⑦ Install the tail PC link and confirm everything moves smoothly.

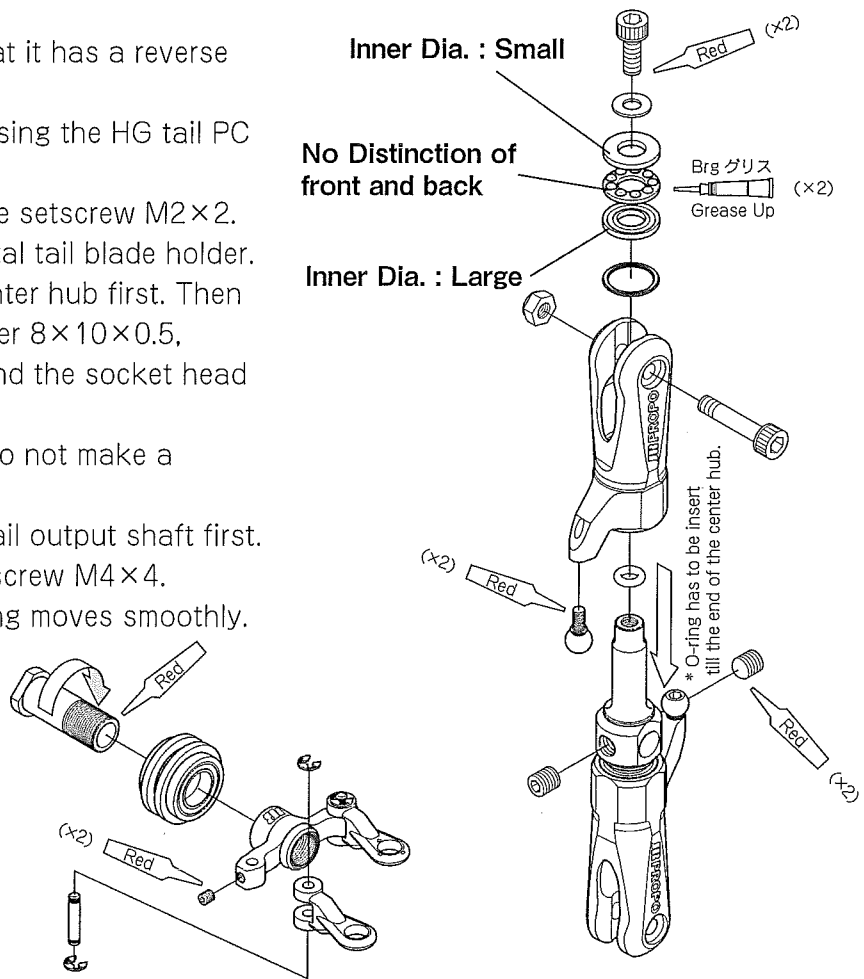

【Parts List】

Item #	Description	Qty	Note
60556	Tail PC Link B	×2	w/Link Pin·E Ring Stopper M1.5
61201	Tail Slide Ring	×1	w/Bearing
61777	HG Metal Tail Blade Holder	×1	w/Bearing·Joint Ball Screw
61778	HG Tail Center Hub \varnothing 5	×1	w/Setscrew M4×4
61779	HG Tail Center Hub \varnothing 6	×1	w/Setscrew M4×4
61780	HG Metal Tail PC Plate	×1	w/Setscrew M2×2·Link·Link Pin
70163	O-ring 3.5×5.5×1	×2	
70293	HG Tail PC Link Pin	×2	
70528	Tail Slide Ring Sleeve	×1	for \varnothing 5
70545	Washer 8×10×0.5	×2	Spindle Shim Washer
70661	Joint Ball Screw L4	×5	
80004	Setscrew M4×4	×10	
80013	Socket Head Bolt M3×8	×10	
80036	Flat Washer M3	×10	
80039	Nylon Lock Nut M3 (t2.8)	×10	
80200	Tail Blade Bolts Set	×1	M3×15 w/Nylon Lock Nut M3
80245	Setscrew M2×2	×5	w/HEX Wrench 0.89
81016	E Stopper Ring M1.5	×10	
81029	Thrust Bearing 5×10×4	×2	T5-10
81071	Shielded Bearing 6×10×3	×2	L-1060ZZ
96330	Tail Slide Ring Sleeve	×1	for \varnothing 6