

No. 96414

Flybarless Rotor Head 90 Complete Set Instruction Manual

No. 96415

Flybarless Rotor Head 90 Conversion Set Instruction Manual

[Contents]

Complete Set Parts		Conversion Set Part	
Flybarless Main Rotor Head Assembly	1	Flybarless Center Hub	1
Drag Bolt M5 × 37	2	Damper Rubber	2
Nylon Lock Nut M5	2	Spindle Shaft(90)	1
Rotor Spacer t3	4	Spindle Shaft Washer M6	2
		Button Head Bolt M6 × 10	2
Common parts			
Flybarless Washout Arm Assembly			2
Washer 03 × 4.5 × 1			2
Ball Arm L4(Screw part L22)			2
Button Head Bolt M4 × 8			2
Special Socket Head Bolt M4×26			1
Socket Head Bolt M2.6 × 8			2
Nylon Lock Nut M4			1
Threaded Rod M2.3 × 60			2
Threaded Rod M2.3 × 85			2
Universal Link			8

[Preparation]

If you have purchased the full flybarless head(complete set) please first remove the main rotor head,Washout Assembly and Linkages from your helicopter.

If you are convertuing an existing rotor head(using the conversion set) please first remove the main rotor head,Washout Assembly and Linkages from your helicopter as above. Next disassemble the removed Rotor head keeping the Main rotor grips,Spindle Shaft tube, Spindle shim washer,Grip spacer,Thrust washer, Dome,Rotor spacer t3,Drag bolts M5 × 37 and M5 nylock nuts to use again.

1-1 Main Rotor Grip Assembly 1

※ If you are using the conversion set, it's not necessary to go thru Step 1-1 to 1-3, remove the main rotor grips with mixing arms, Spindle Shaft tube, Spindle Shim Washer, Grip Spacer, Thrust Washer and Dome

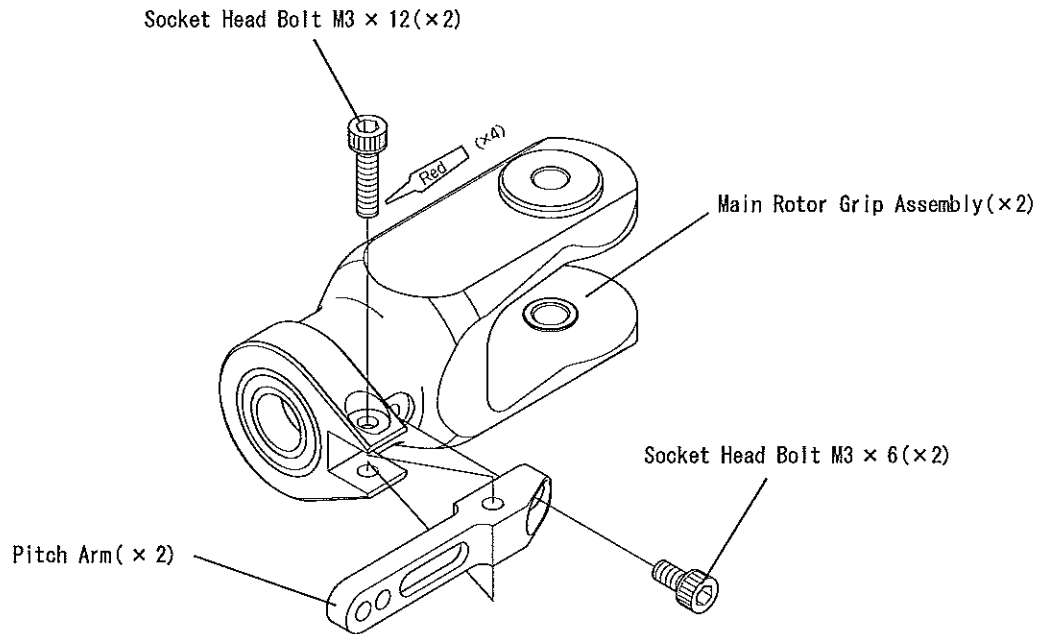

1-2 Mixing Arm Assembly 1

NOTE : The direction of Mixing Arm and Position of Joint Ball.

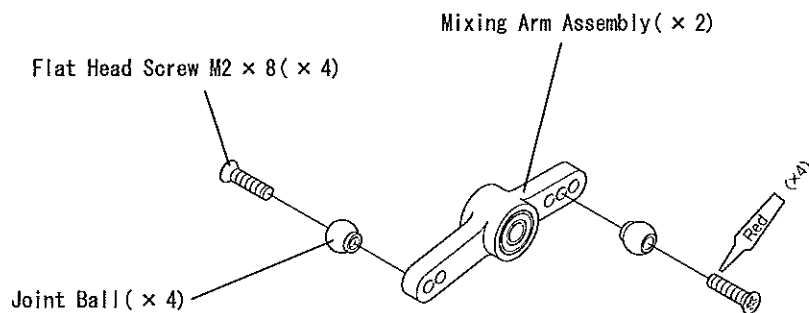

1-3 Main Rotor Grip Assembly 2

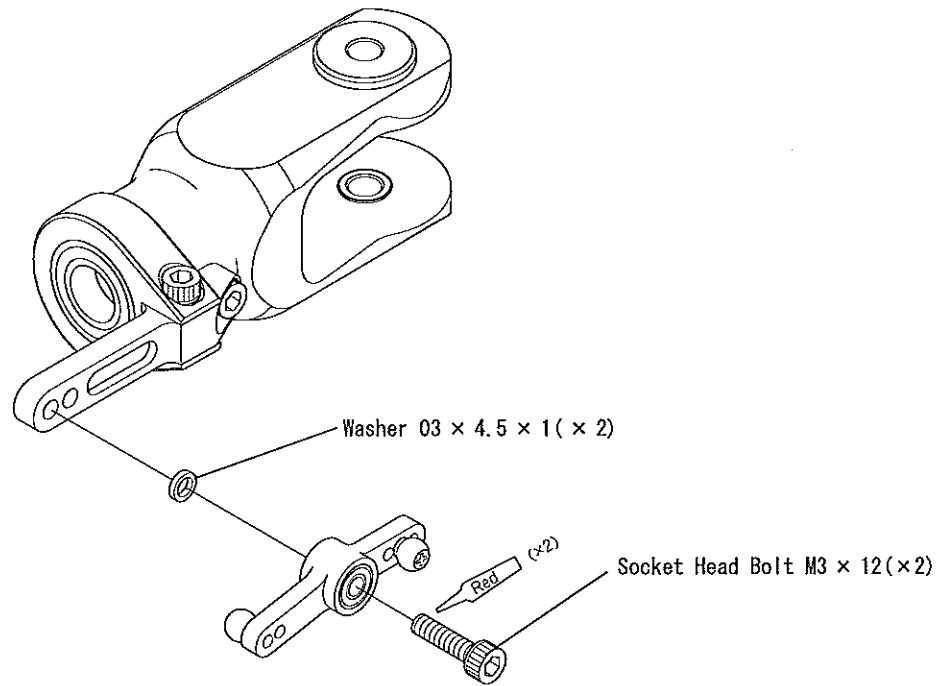

2-1 Spindle Shaft Assembly

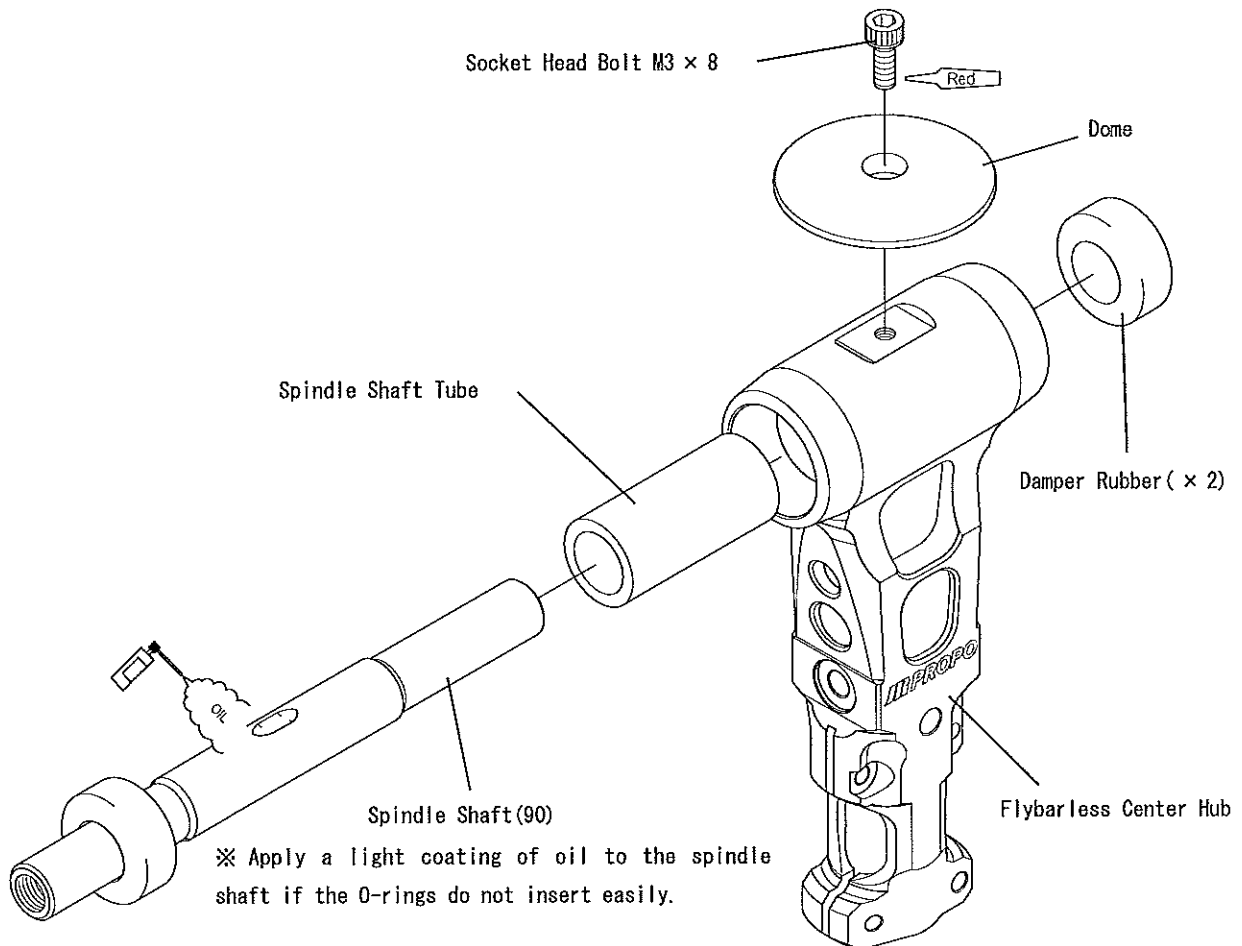

2-2 Main Rotor Head Assembly 1

Note: Install Thrust Bearing toward mainshaft, exposed balls to Blade side of grip. (The thrust race will keep grease in, and positioning the cage this way will prevent any possible cage deformation from balls jamming on the cage that will be thrown outward during use.)

Note the proper direction of Grip Spacer.
Blade Holder Center Hub

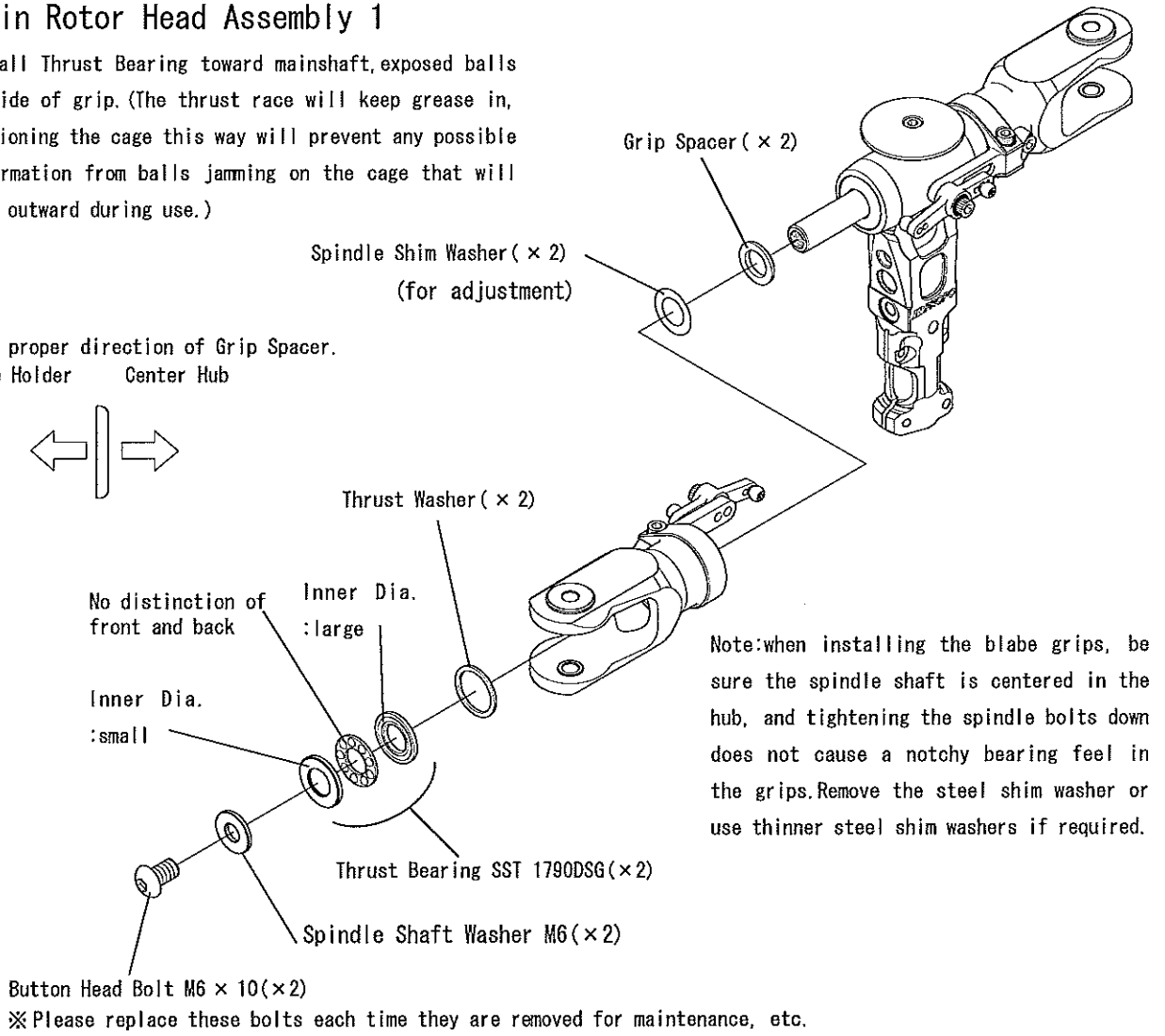
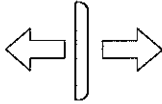

2-3 Main Rotor Head Assembly 2

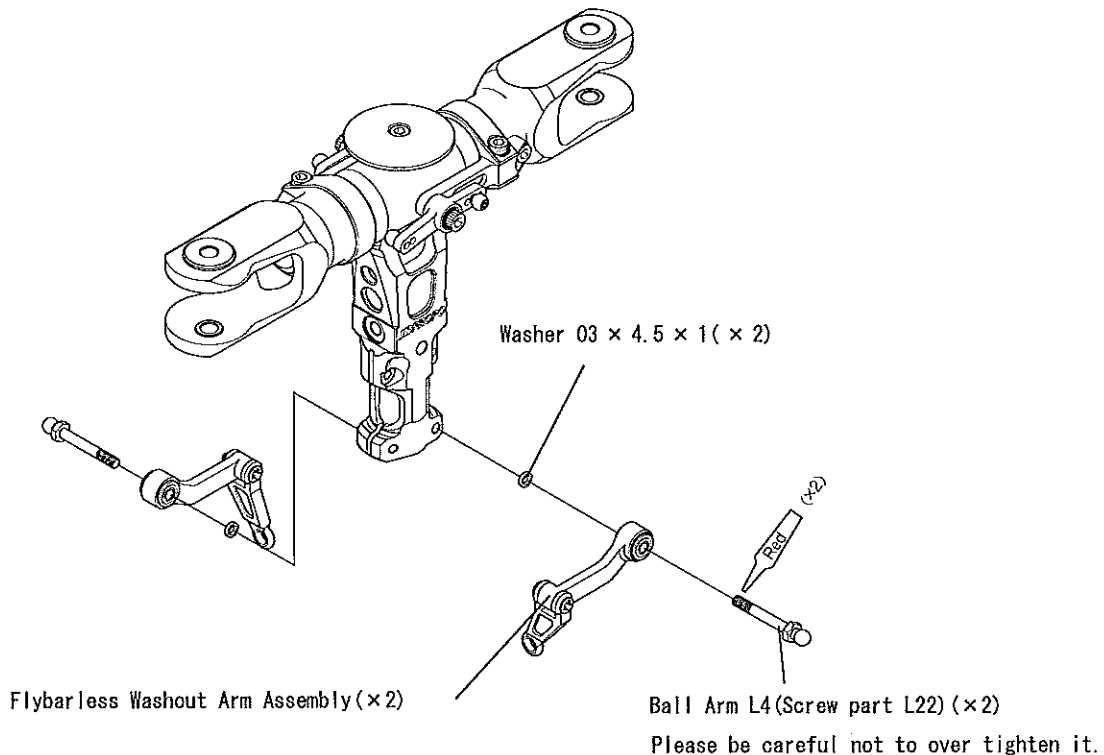

2-4 Main Rotor Head Installation

For VIBE 90SG

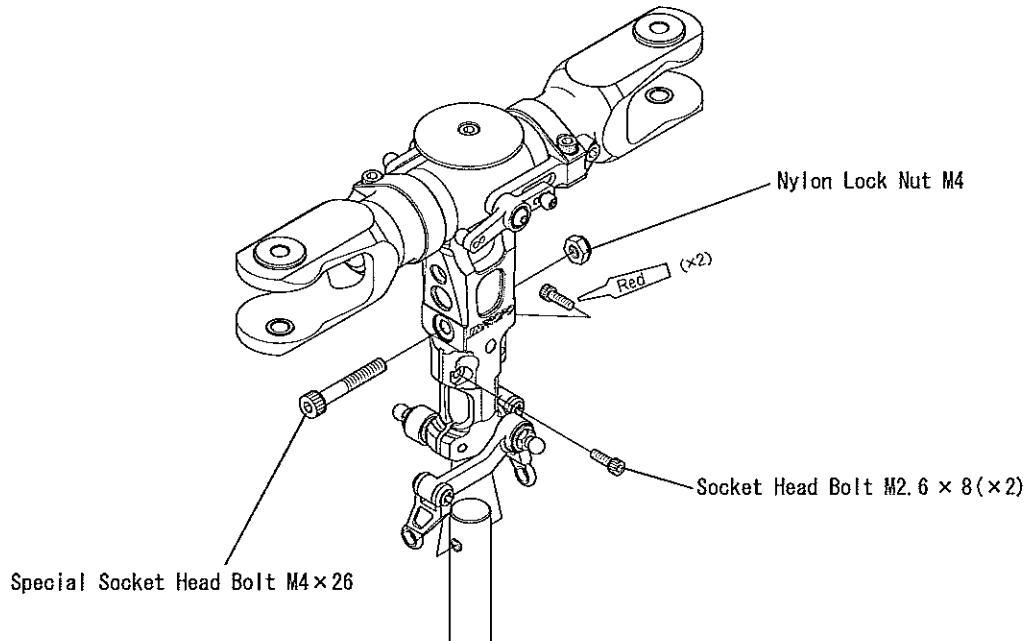

For AIRSKIPPER 90

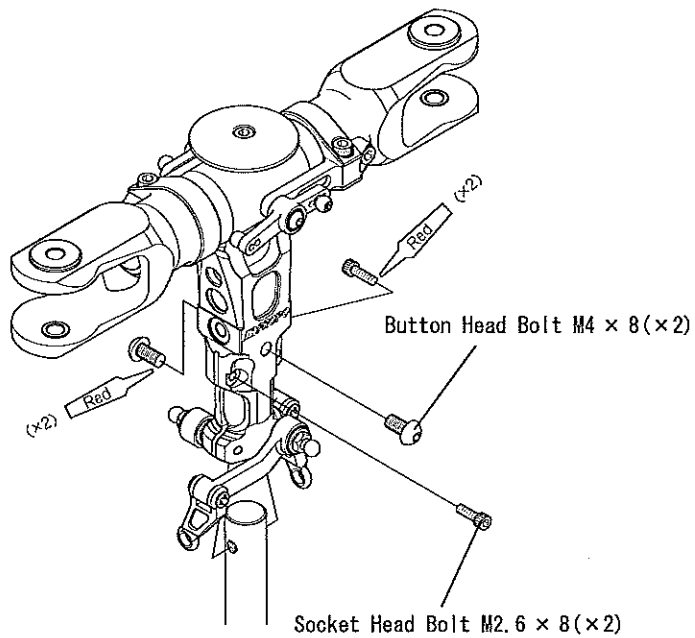

3-1 Linkages

Make two sets.

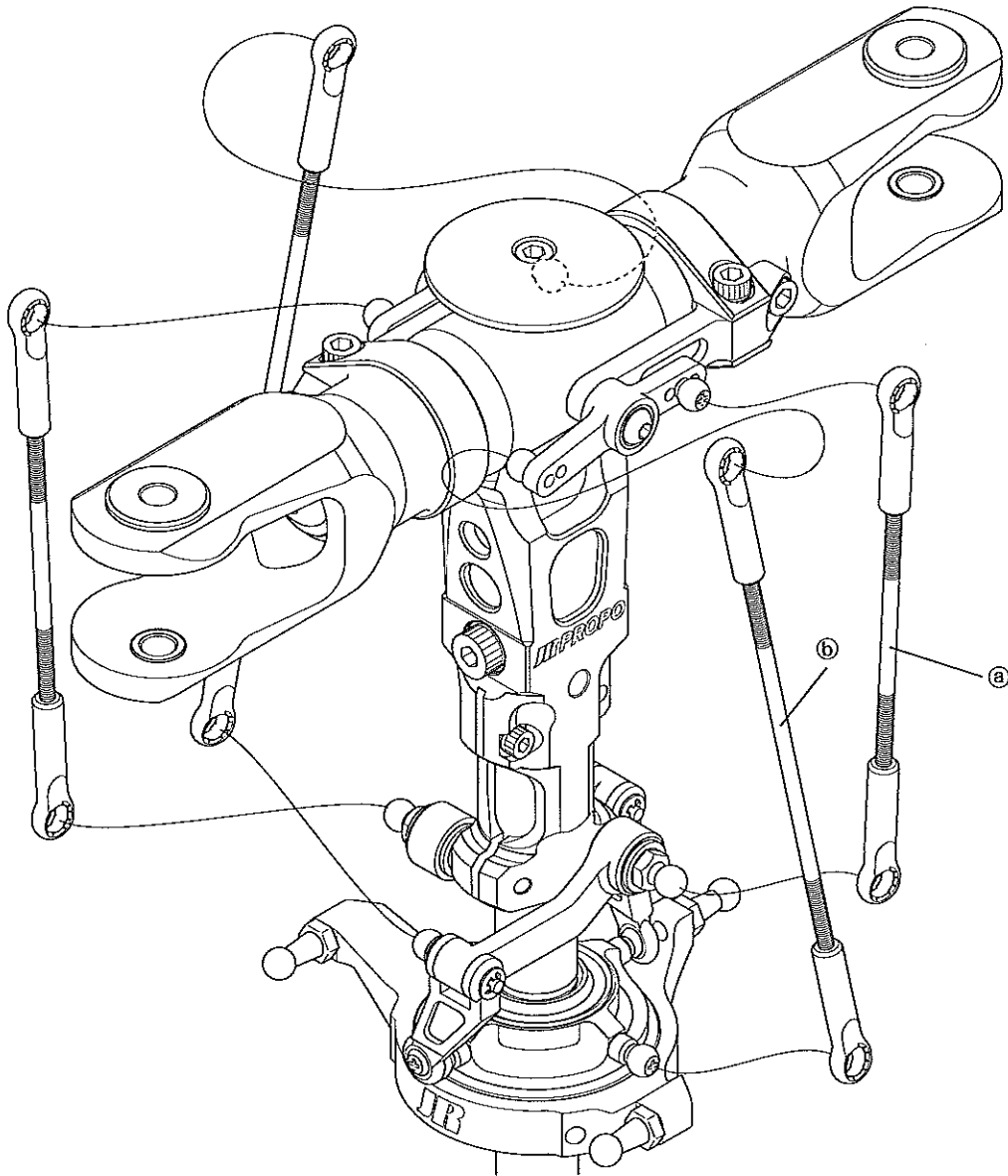
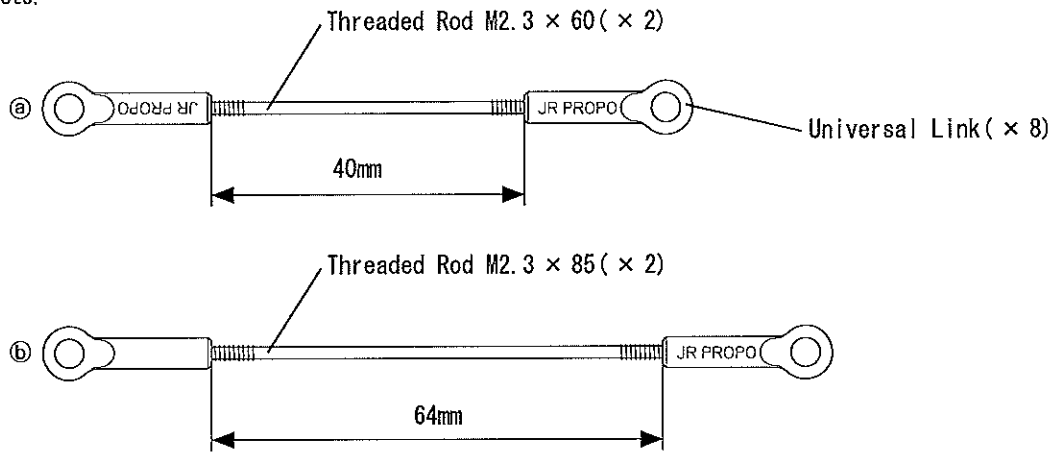

Screw the universal links onto the threaded rods while referring to the above figure.

Attach the washout links to the upper swashplate balls as shown.

3-2 Main Rotor Blade Installation

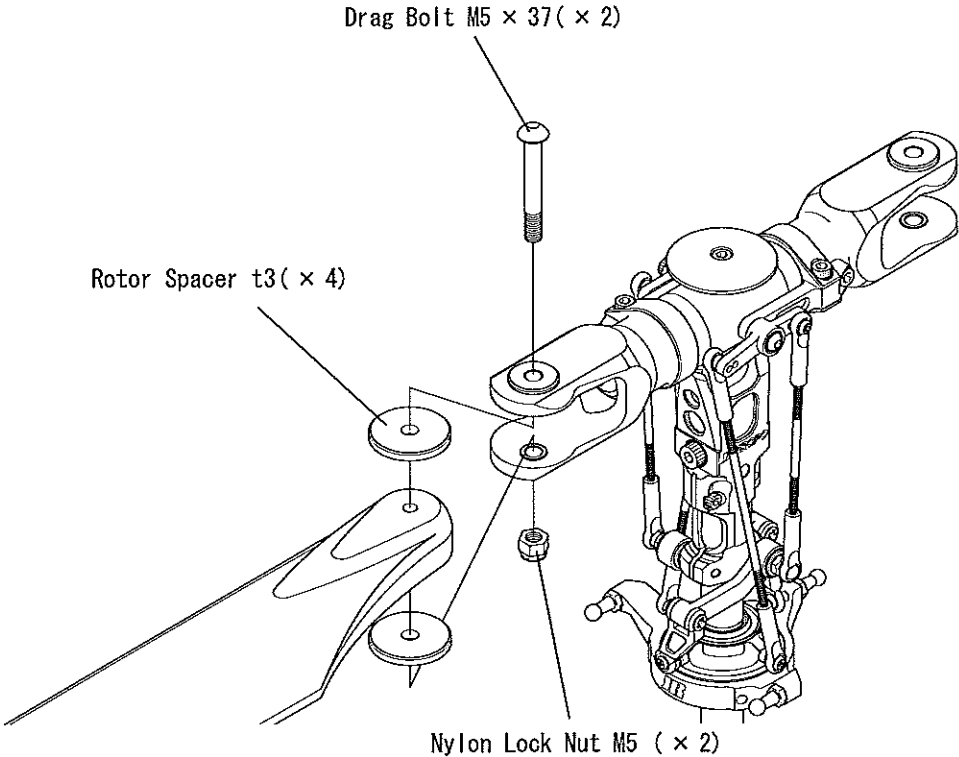

Adjustment

Please refer to your gyro (stabilisation system) manual for setting and adjustment.

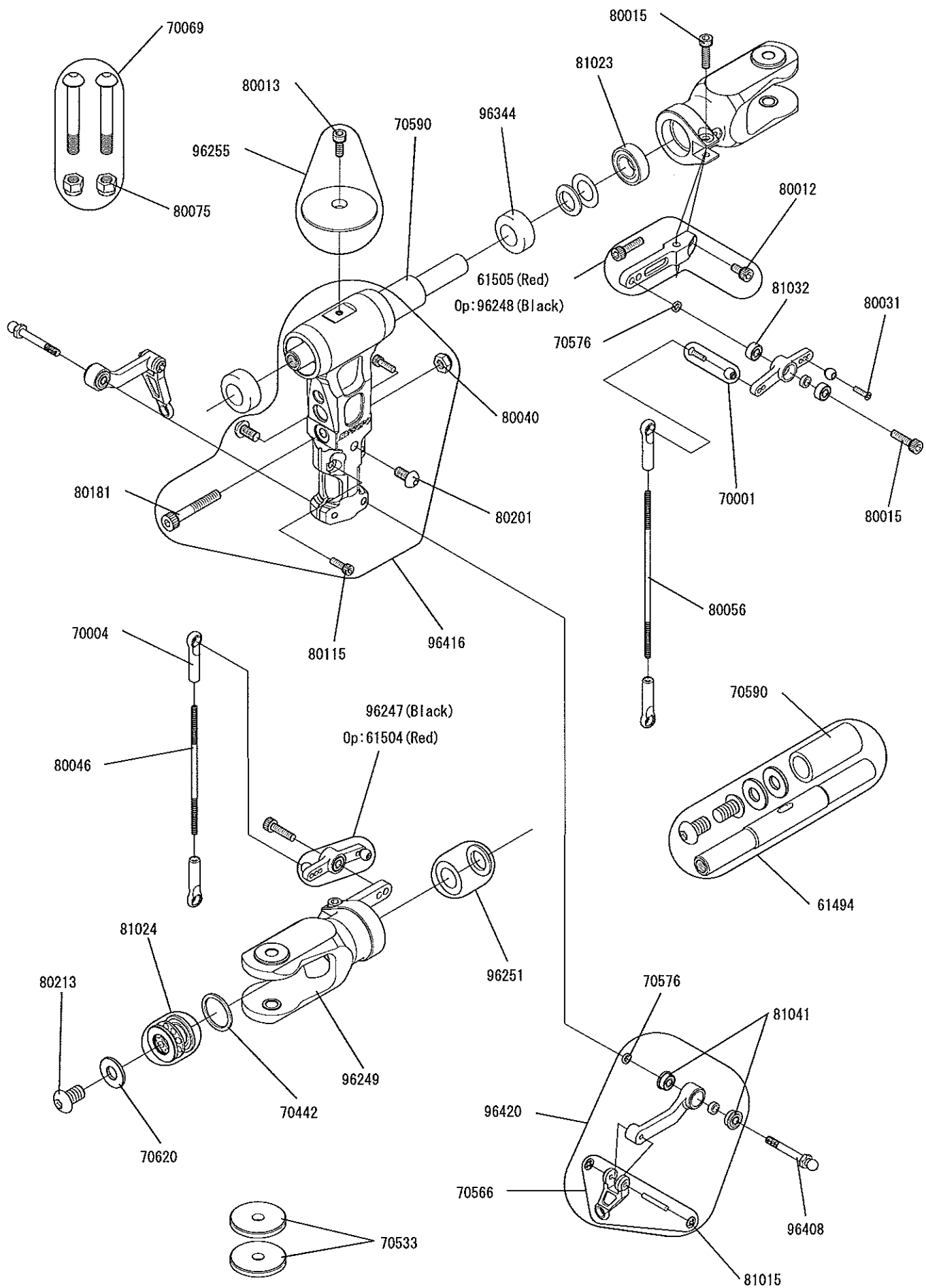

61494	Spindle Shaft 90	×1	w/Spindle Shaft Tube · Spindle Washer M6 · Button Head Bolt M6×10
61504	Mixing Arm Set w/Bearing(Red)	×2	L-730ZZ Bearing Option
61505	Pitch Arm(Red)	×1	w/Socket Head BoltM3×6 · M3×12
70001	Joint Ball A	×10	w/Flat Head Screw, M2 x 8
70004	Universal Link	×10	
70069	Drag Bolt Set M5×37	×1	w/Nylon Nut M5
70442	Thrust Washer	×2	
70533	Rotor Spacer t3	×4	
70566	Washout Link B	×2	w/Washout Link Pin
70576	Washer 03 × 4.5 × 1	×2	
70590	Spindle Shaft Tube	×1	
70620	Spindle Washer M6	×2	
80012	Socket Head Bolt M3×6	×10	
80013	Socket Head Bolt M3×08	×10	
80015	Socket Head Bolt M3×12	×10	
80031	Flat Head Screw M2×8	×10	
80040	Nylon Lock Nut M4(t5.5)	×10	
80046	Threaded Rod M2.3×60	×2	
80056	Threaded Rod M2.3×85	×2	
80075	Nylon Lock Nut M5	×10	
80115	Socket Head Bolt M2.6×08	×10	
80181	Special Socket Head Bolt M4×26	×2	
80201	Button Head Bolt M4×8	×10	
80213	Button Head Bolt M6×10	×10	
81015	CA Stopper Ring M2	×10	
81023	Shielded Bearing 09×17×5	×2	L-1790ZZ
81024	Thrust Bearing 09×17×5	×2	SST-1790DSG
81032	Shielded Bearing 03×07×3	×2	L-730ZZ
81041	Shielded Bearing F03×07×3	×2	LF-730ZZ
96247	Mixing Arm Set w/Bearing(Black)	×2	L-730ZZ Bearing
96248	Pitch Arm(Black)	×1	w/Socket Head BoltM3×6 · M3×12 Option
96249	Main Rotor Grip Assembly	×2	w/L-1480ZZ Bearing
96251	Grip Spacer Set	×1	w/Spindle Shim Washer
96255	Dome	×1	w/Socket Head Bolt M3×8
96344	Damper Rubber	×4	90°
96408	Ball Arm L4(Screw part L22)	×2	
96416	Flybarless Center Hub	×1	w/Bolt set
96420	Flybarless Washout Arm Assembly	×2	R-830ZZ Bearing

Fly, and catch the sky with JR!

JR PROPO®

<http://www.jrpropo.co.jp/>